

SGB[®]-High Capacity

YOUR BEST CHOICE OF QUALITY

1



The SGB[®]-High Capacity comes in a set of hermetic liner and Flexible Intermediate Bulk Container (FIBC). Check SGB[®]-High Capacity for holes and tears before using. Insert the liner inside the FIBC all the way through the downspout.

2

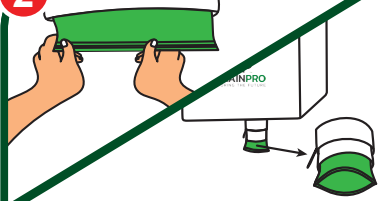

Close the zipper of the liner downspout using the zipper slider and insert it inside the downspout of the FIBC.

3



Roll-up the downspout of the liner and tie the downspout of the FIBC.

4



Close the downspout chute. Then, close or tie the bottom "bonnet".

5

Manual Loading



Pour the commodities gently into the hermetic liner. Make sure there is no spillage in between the liner and the bag.

Mechanical Loading



6

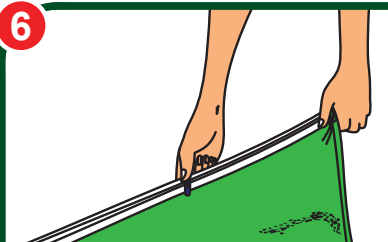

Seal the zipper by inserting the slider at one end. Move slider to the other end to engage corresponding tracks.

NOTE: Two persons are required for easy zipping. One will do the zipping and the second person will hold the other end steady making both sections of the zipper straight line to avoid zipper length difference.

7



Close the duffle to protect and cover the liner completely.

8

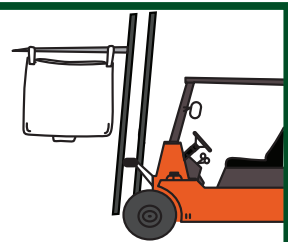

To unload, elevate the bag.

9

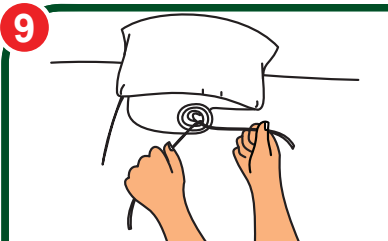

Untie or open the bottom "bonnet" and the downspout chute. Pull the liner's downspout and manually open the zip-lock.

10

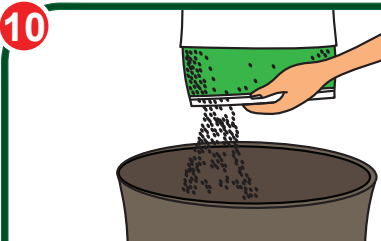

Slowly provide an opening until grains start to fall.

SGB[®]-High Capacity

LINER

325 x 240 cm

128 x 94.5 inches

COMPLETE

115 x 110 x 115 cm

45 x 43 x 45 inches



SGB[®]-High Capacity

YOUR BEST CHOICE OF QUALITY

1



The SGB[®]-High Capacity comes in a set of hermetic liner and Flexible Intermediate Bulk Container (FIBC). Check SGB[®]-High Capacity for holes and tears before using. Insert the liner inside the FIBC all the way through the downspout.

2

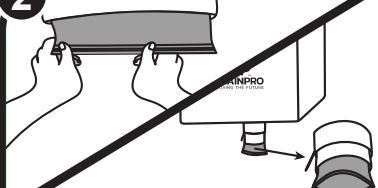

Close the zipper of the liner downspout using the zipper slider and insert it inside the downspout of the FIBC.

3



Roll-up the downspout of the liner and tie the downspout of the FIBC.

4

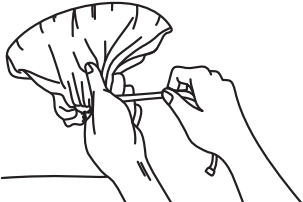

Close the downspout chute. Then, close or tie the bottom "bonnet".

5

Manual Loading



Pour the commodities gently into the hermetic liner. Make sure there is no spillage in between the liner and the bag.

Mechanical Loading



6

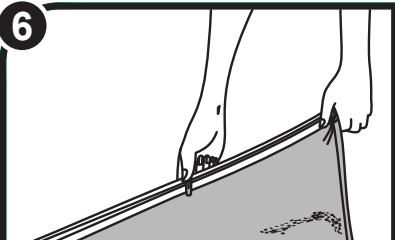

Seal the zipper by inserting the slider at one end. Move slider to the other end to engage corresponding tracks.

NOTE: Two persons are required for easy zipping. One will do the zipping and the second person will hold the other end steady making both sections of the zipper straight line to avoid zipper length difference.

7



Close the duffle to protect and cover the liner completely.

8

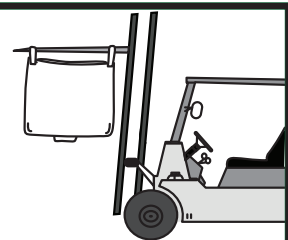

To unload, elevate the bag.

9

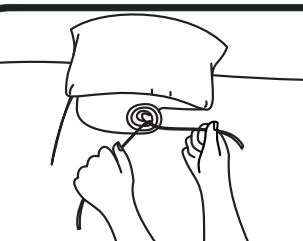

Untie or open the bottom "bonnet" and the downspout chute. Pull the liner's downspout and manually open the zip-lock.

10

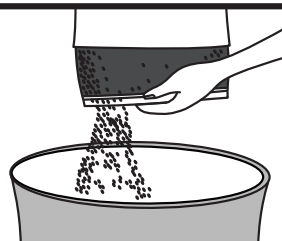

Slowly provide an opening until grains start to fall.

SGB[®]-High Capacity

LINER

325 x 240 cm

128 x 94.5 inches

COMPLETE

115 x 110 x 115 cm

45 x 43 x 45 inches

MA4017MSD1110 -3

Scan me



Storing the Future. Best choice for quality preservation.